

□ 60 Gear Ratio 1/3 ~ 1/250



FEATURES

- Gear Ratios optimized for DC motor
- High Efficiency
- Low Noise & Low Vibration
- A wide range of applications

DIMENSIONS

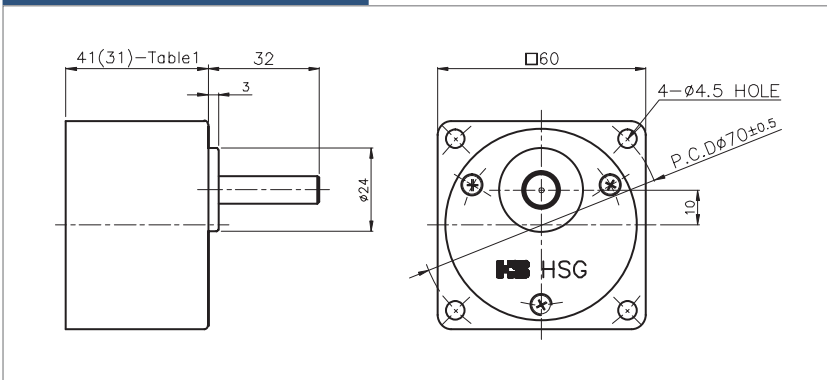

※ TABLE 1

| Gear Ratio | SIZE |
|--------------|------|
| 1:03 ~ 1:18 | 31mm |
| 1:20 ~ 1:250 | 41mm |

GEAR HEAD OUTPUT SHAFT

| | |
|------------------------|--|
| D-CUT TYPE HG6-()D | |
| KET TYPE HG6-()K | |
| KET SPEC | |

Maximum permissible torque of Gear Head

| Model | Gear Ratio | 3 | 3.6 | 5 | 6 | 7.5 | 9 | 10 | 12.5 | 15 | 18 | 20 | 25 | 30 | 36 | 40 | 50 | 60 | 75 | 90 | 100 | 120 | 150 | 180 | 200 | 250 | |
|--------------------------|--------------------|--------|------|------|------|------|------|------|------|------|------|------|------|------|------|------|------|------|------|------|------|------|------|------|-----|-----|----|
| Geared Motor: HGM6-1024A | Speed (No Load) | rpm | 1100 | 917 | 660 | 550 | 440 | 367 | 330 | 264 | 220 | 183 | 165 | 132 | 110 | 92 | 83 | 66 | 55 | 44 | 37 | 33 | 28 | 22 | 18 | 17 | 13 |
| | Gear Head: HG6-() | Torque | N·m | 0.08 | 0.10 | 0.13 | 0.16 | 0.20 | 0.24 | 0.27 | 0.33 | 0.40 | 0.48 | 0.48 | 0.60 | 0.72 | 0.87 | 0.96 | 1.08 | 1.30 | 1.62 | 1.92 | 2.17 | 2.60 | 3 | 3 | 3 |
| | | kgf·cm | 0.8 | 1.0 | 1.3 | 1.6 | 2.0 | 2.4 | 2.7 | 3.3 | 4.0 | 4.8 | 4.8 | 6.0 | 7.2 | 8.7 | 9.6 | 10.8 | 13.0 | 16.2 | 19.5 | 21.7 | 26.0 | 30 | 30 | 30 | 30 |
| Geared Motor: HGM6-1524A | Speed (No Load) | rpm | 1133 | 944 | 680 | 567 | 453 | 378 | 340 | 272 | 227 | 189 | 170 | 136 | 113 | 94 | 85 | 68 | 57 | 45 | 38 | 34 | 28 | 23 | 19 | 17 | 14 |
| | Gear Head: HG6-() | Torque | N·m | 0.12 | 0.15 | 0.20 | 0.24 | 0.30 | 0.36 | 0.41 | 0.51 | 0.61 | 0.73 | 0.73 | 0.91 | 1.09 | 1.31 | 1.46 | 1.64 | 1.97 | 2.46 | 2.95 | 3 | 3 | 3 | 3 | 3 |
| | | kgf·cm | 1.2 | 1.5 | 2.0 | 2.4 | 3.0 | 3.6 | 4.1 | 5.1 | 6.1 | 7.3 | 7.3 | 9.1 | 10.9 | 13.1 | 14.6 | 16.4 | 19.7 | 24.6 | 29.5 | 30 | 30 | 30 | 30 | 30 | 30 |
| Geared Motor: HGM6-3024A | Speed (No Load) | rpm | 1133 | 944 | 680 | 567 | 453 | 378 | 340 | 272 | 227 | 189 | 170 | 136 | 113 | 94 | 85 | 68 | 57 | 45 | 38 | 34 | 28 | 23 | 19 | 17 | 14 |
| | Gear Head: HG6-() | Torque | N·m | 0.24 | 0.29 | 0.41 | 0.49 | 0.61 | 0.73 | 0.81 | 1.01 | 1.22 | 1.46 | 1.46 | 1.82 | 2.19 | 2.62 | 2.92 | 3 | 3 | 3 | 3 | 3 | 3 | 3 | 3 | 3 |
| | | kgf·cm | 2.4 | 2.9 | 4.1 | 4.9 | 6.1 | 7.3 | 8.1 | 10.1 | 12.2 | 14.6 | 14.6 | 18.2 | 21.9 | 26.2 | 29.2 | 30 | 30 | 30 | 30 | 30 | 30 | 30 | 30 | 30 | 30 |

■ Green color indicates that the output shaft of the geared motor rotates in the same direction as the output shaft of the motor. Others indicate rotation in the opposite direction.