

□ 80 Gear Ratio : 1/3 ~ 1/200



FEATURES

- Gear Ratios optimized for DC motor
- High Efficiency
- Low Noise & Low Vibration
- A wide range of applications

DIMENSIONS

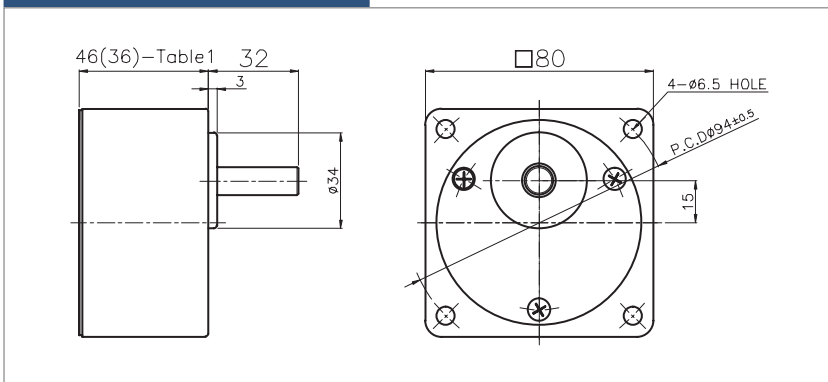

※ TABLE 1

Gear Ratio	SIZE
1:03 ~ 1:18	36mm
1:20 ~ 1:200	46mm

GEAR HEAD OUTPUT SHAFT

D-CUT TYPE HG8-(J)D	
KET TYPE HG8-(J)K	
KEY SPEC	

Maximum permissible torque of Gear Head

Model	Gear Ratio	3	3.6	5	6	7.5	9	10	12.5	15	18	20	25	30	36	40	50	60	75	90	100	120	150	180	200	
Geared Motor: HGM6-2524A	Speed (No Load)	rpm	1100	917	660	550	440	367	330	264	220	183	165	132	110	92	83	66	55	44	37	33	28	22	18	17
	Gear Head: HG8-( )	Torque	N·m	0.19	0.23	0.32	0.39	0.49	0.58	0.65	0.81	0.97	1.17	1.17	1.46	1.75	2.10	2.33	2.62	3.15	3.94	4.72	5.25	6.30	7.87	8
		kgf·cm	1.9	2.3	3.2	3.9	4.9	5.8	6.5	8.1	9.7	11.7	11.7	14.6	17.5	21.0	23.3	26.2	31.5	39.4	47.2	52.5	63.0	78.7	80	80
Geared Motor: HGM6-6024A	Speed (No Load)	rpm	1167	972	700	583	467	389	350	280	233	194	175	140	117	97	88	70	58	47	39	35	29	23	19	18
	Gear Head: HG8-( )	Torque	N·m	0.49	0.58	0.81	0.97	1.22	1.46	1.62	2.03	2.43	2.92	2.92	3.65	4.37	5.25	5.83	6.56	7.87	8	8	8	8	8	8
		kgf·cm	4.9	5.8	8.1	9.7	12.2	14.6	16.2	20.3	24.3	29.2	29.2	36.5	43.7	52.5	58.3	65.6	78.7	80	80	80	80	80	80	80
Geared Motor: HGM8-9024A	Speed (No Load)	rpm	1100	917	660	550	440	367	330	264	220	183	165	132	110	92	83	66	55	44	37	33	28	22	18	17
	Gear Head: HG8-( )	Torque	N·m	0.73	0.87	1.22	1.46	1.82	2.19	2.43	3.04	3.65	4.37	4.37	5.47	6.56	7.87	8	8	8	8	8	8	8	8	8
		kgf·cm	7.3	8.7	12.2	14.6	18.2	21.9	24.3	30.4	36.5	43.7	43.7	54.7	65.6	78.7	80	80	80	80	80	80	80	80	80	80

■ Green color indicates that the output shaft of the geared motor rotates in the same direction as the output shaft of the motor. Others indicate rotation in the opposite direction.